

# Total Space Requirements

	<u>Existing</u>	<u>Needs</u>	<u>Difference</u>
Art & Art History	37,642	40,732	(3,090)
Theater and Dance	35,099	33,018	2,081
Music	29,627	29,949	(322)
Museum of Art	7,064	12,075	(5,011)
General	0	9,699	(9,699)
Interdisciplinary	<u>0</u>	<u>23,335</u>	<u>(23,335)</u>
<b>TOTAL</b>	<b>109,432</b>	<b>148,808</b>	<b>(39,376)</b>

# Space Distribution

	<u>CFA (ph1)</u>	<u>PCAC</u>	<u>NHH</u>	<u>Service</u>
Art & Art History	0	22,800	0	17,932
Theater and Dance	0	27,760	5,258	0
Music	11,821	18,128	0	0
Museum of Art	1,000	11,075	0	0
General	6,107	3,592	0	0
Interdisciplinary	<u>23,335</u>	<u>0</u>	<u>0</u>	<u>0</u>
<b>TOTAL</b>	<b>42,263</b>	<b>83,355</b>	<b>5,258</b>	<b>17,932</b>
	<b>+ 42,263</b>	<b>- 2,887</b>	<b>0</b>	<b>0</b>

# Phase 1 Options

<u>Scenario</u>	<u>ASF</u>	<u>Difference</u>
Current CFA Program (Phase 1)	42,263	0
Remove Visualization Suite	38,813	(3,450)
Remove 100% Residence	39,228	(3,035)
Include Museum (No Storage)	51,338	9,075
Program Reduction/50% Res	37,353	(4,910)

# Center for the Arts Program – Full Build

## Music

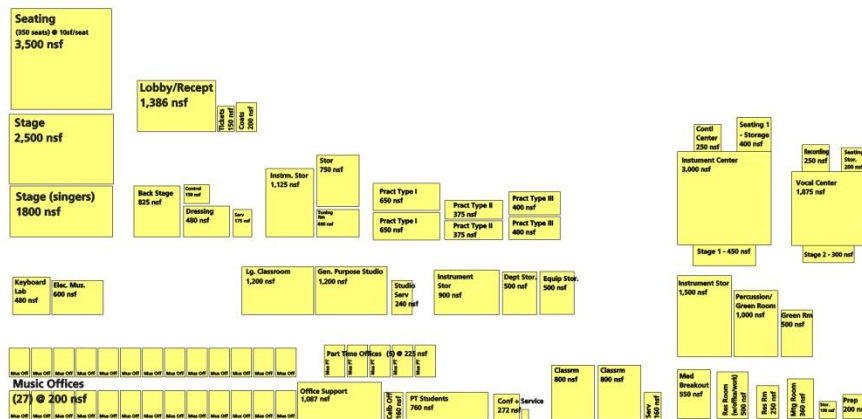

## Artist Residences



## Support

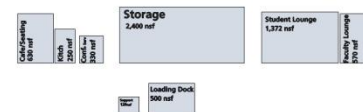

## Museum

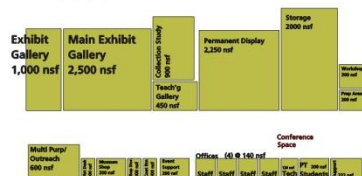

## Theater & Dance

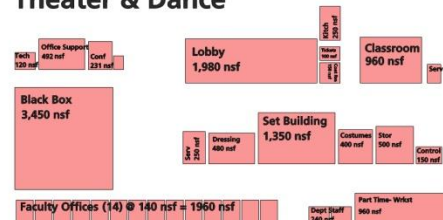

**Theater Seating**  
5,000 nsf

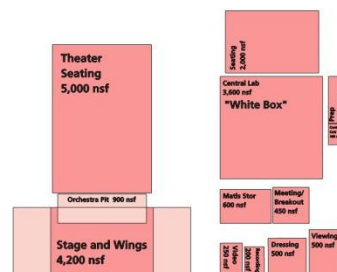

## Art & Art History

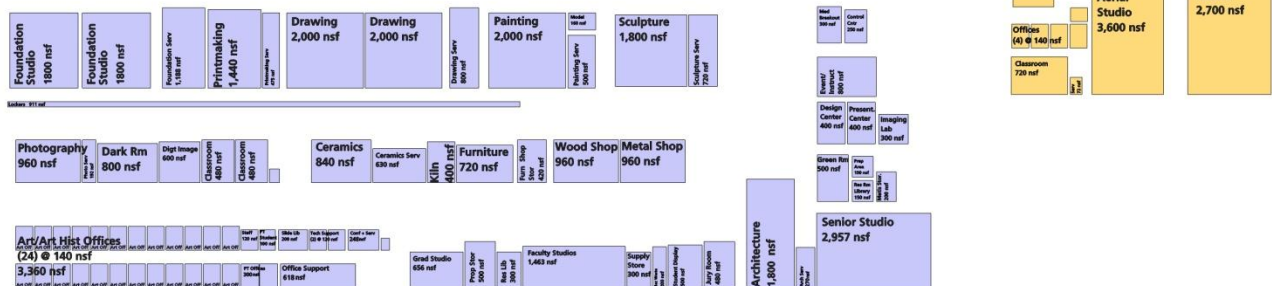

# Center for the Arts Program – Phase I Elements

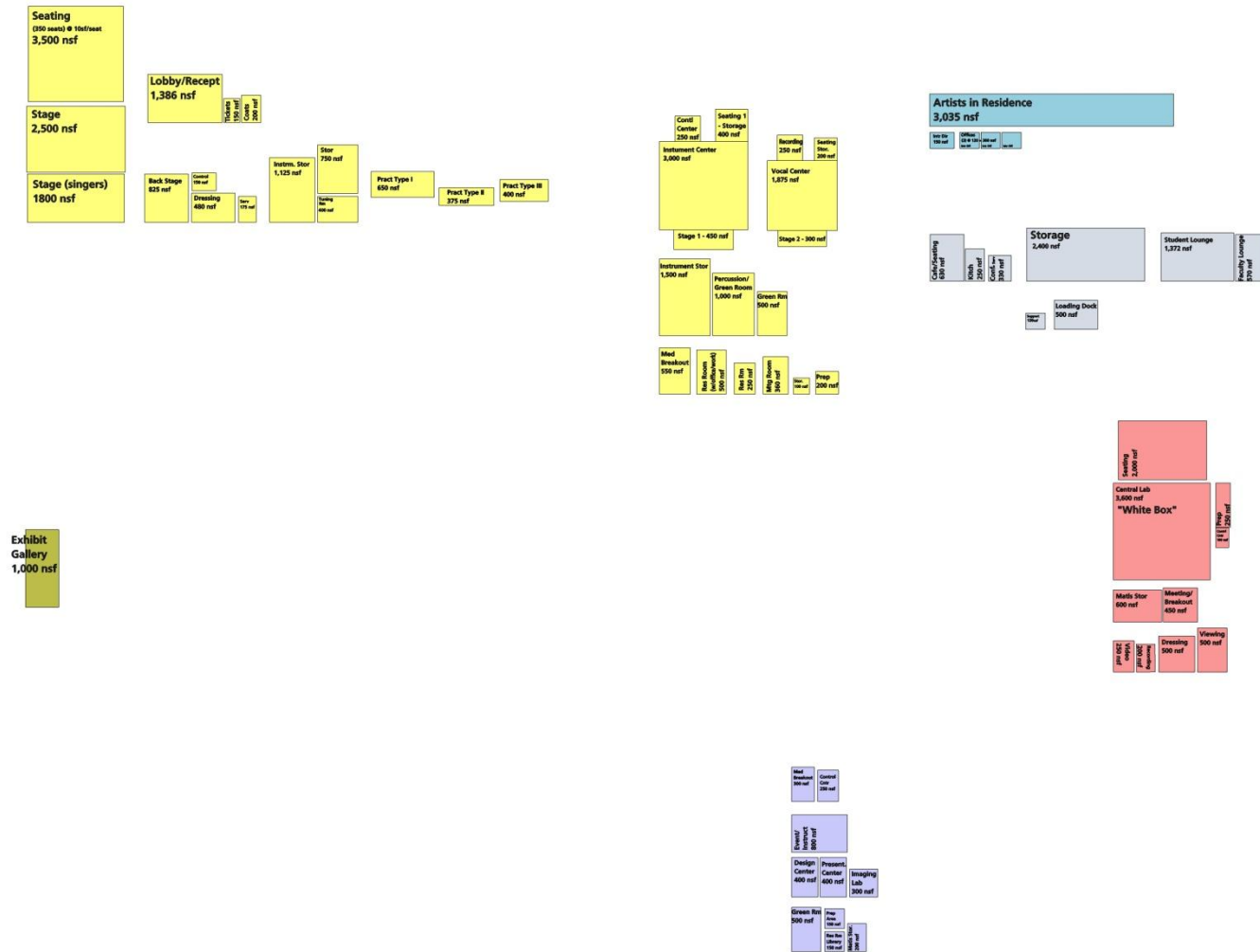

## Phase I

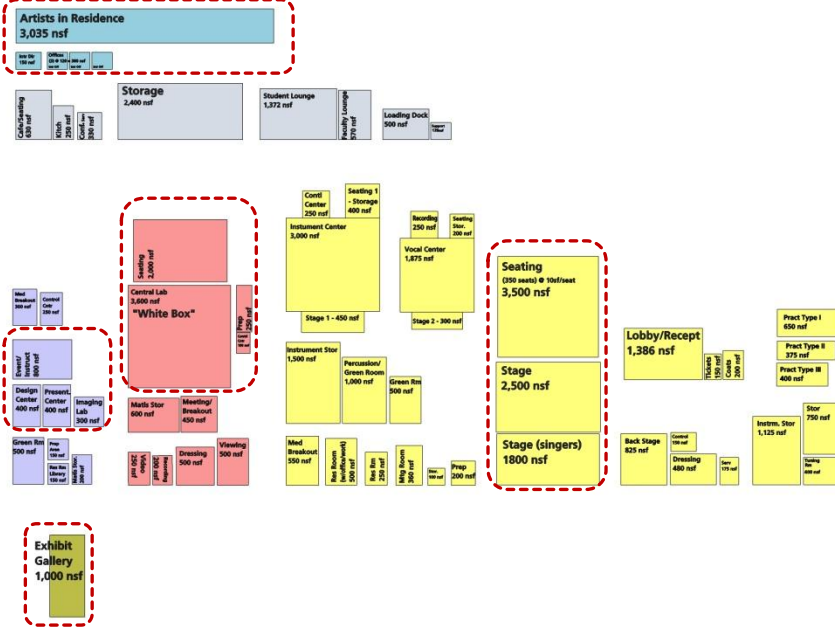

## Option 1 – Add The Museum

## Phase I

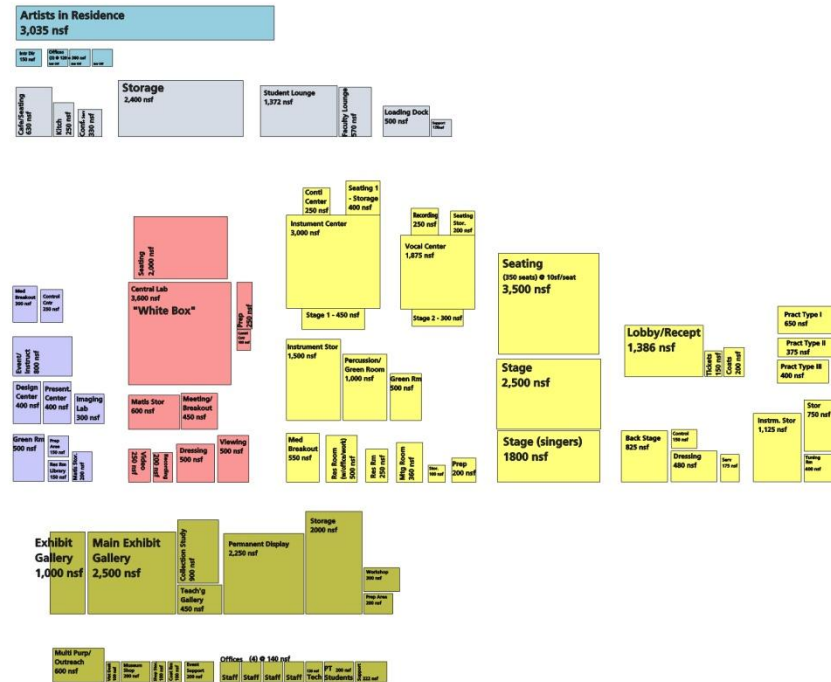

## Center for Arts Site Options

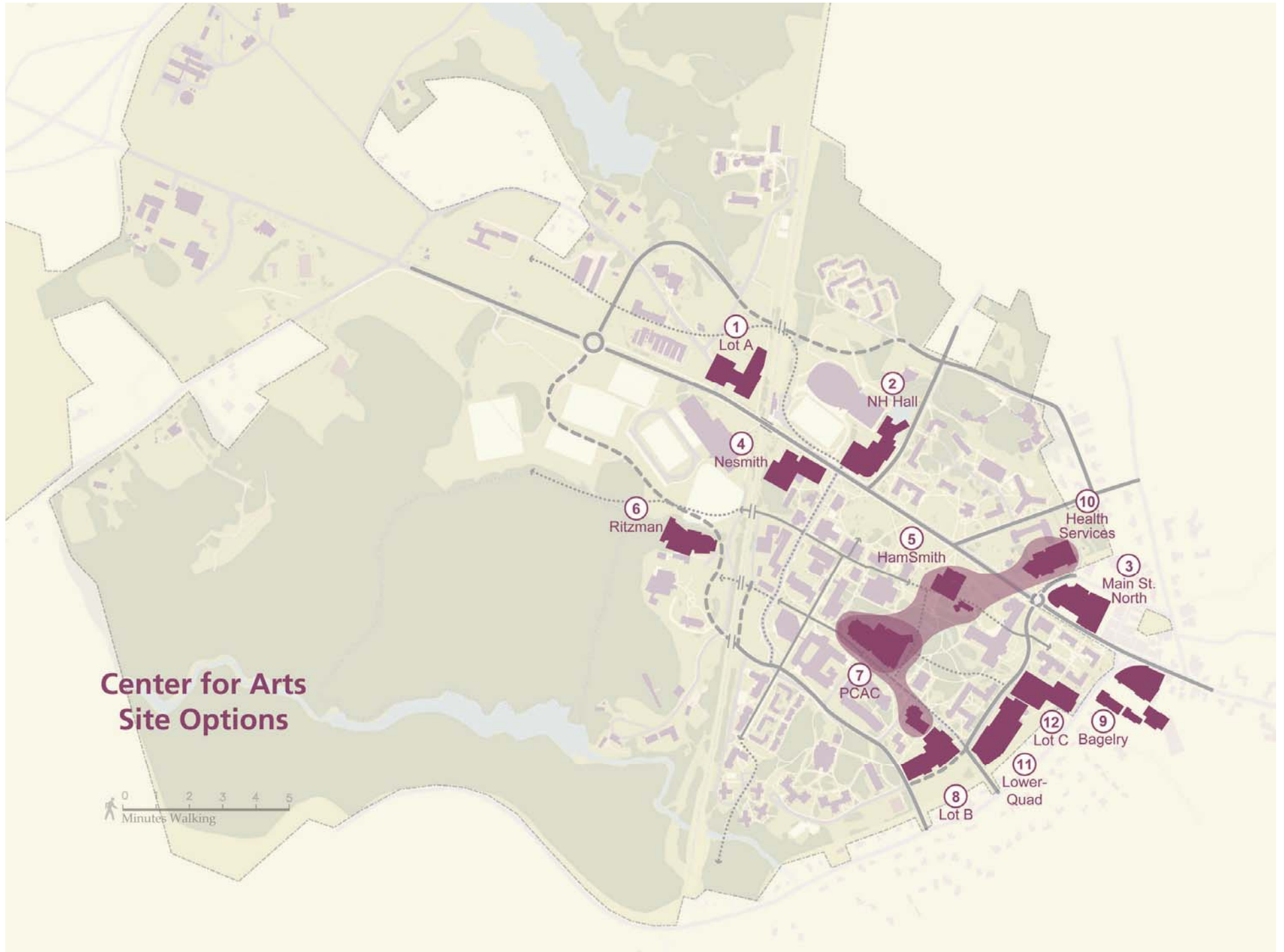





## Center for Arts

Recommended Site: Adjacent to Lot C

11 12  
Lower-Quad / Lot C

## Illustration of walking times





# Phase 1 – Center for Arts

Examples of the functions that would be included in Phase 1

## Flexible Performance / Presentation Hall

Instrumental & Vocal Performances, Films, Presentations

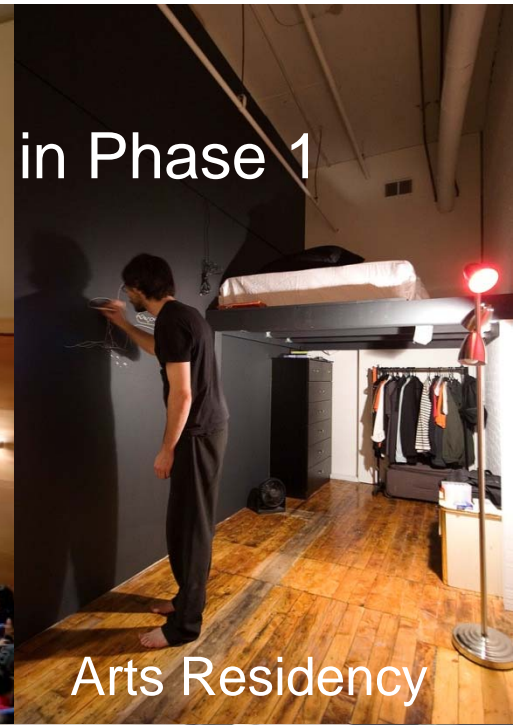

Arts Residency

## White Box Theater



Gallery

Center for the Arts adjacent to Lot C, near Lot B, proximate to downtown, and other campus public venue buildings

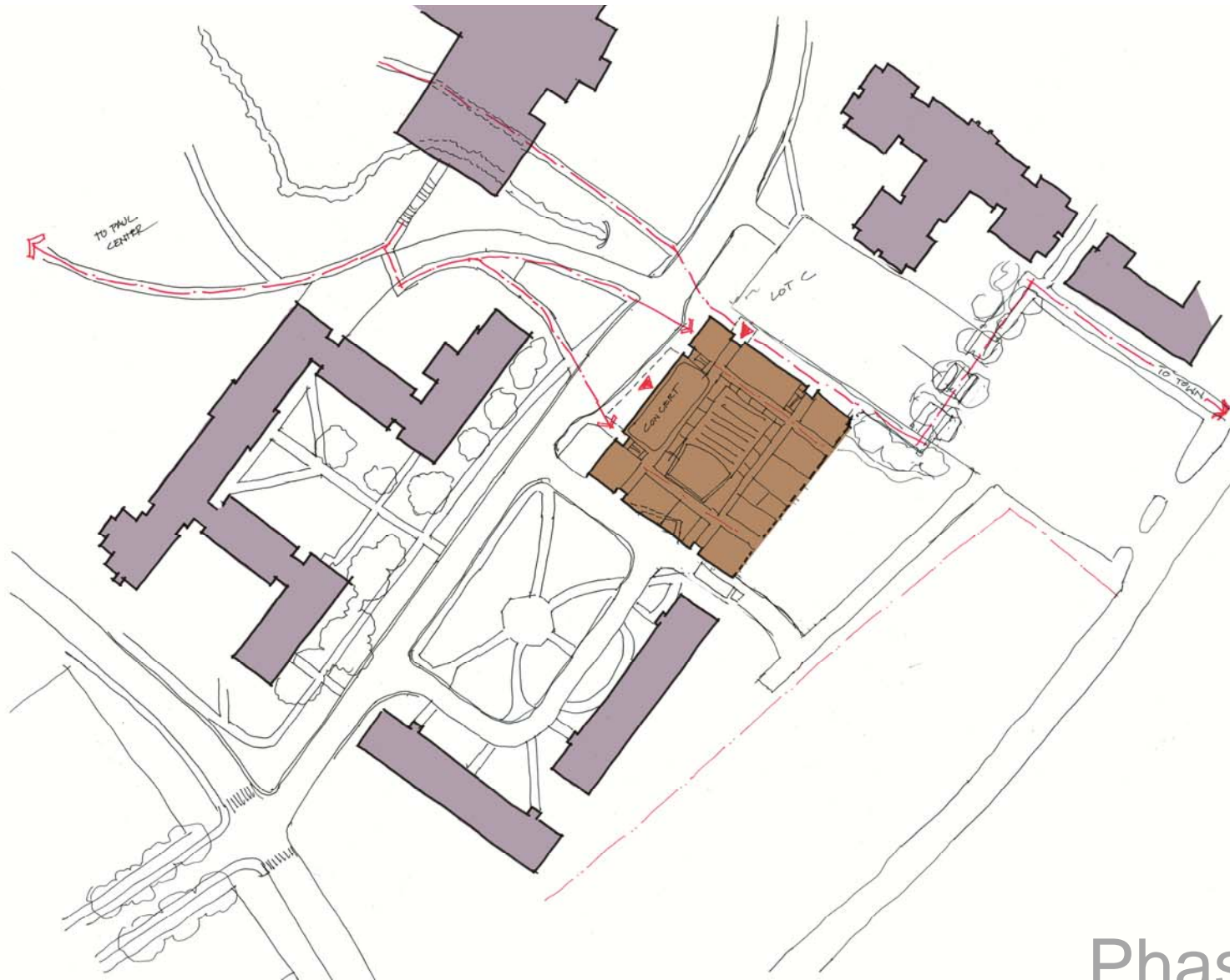

Phase 1  
Engelhardt Demolished



There are 3 options for the Future Full Build Out of the Center for the Arts.

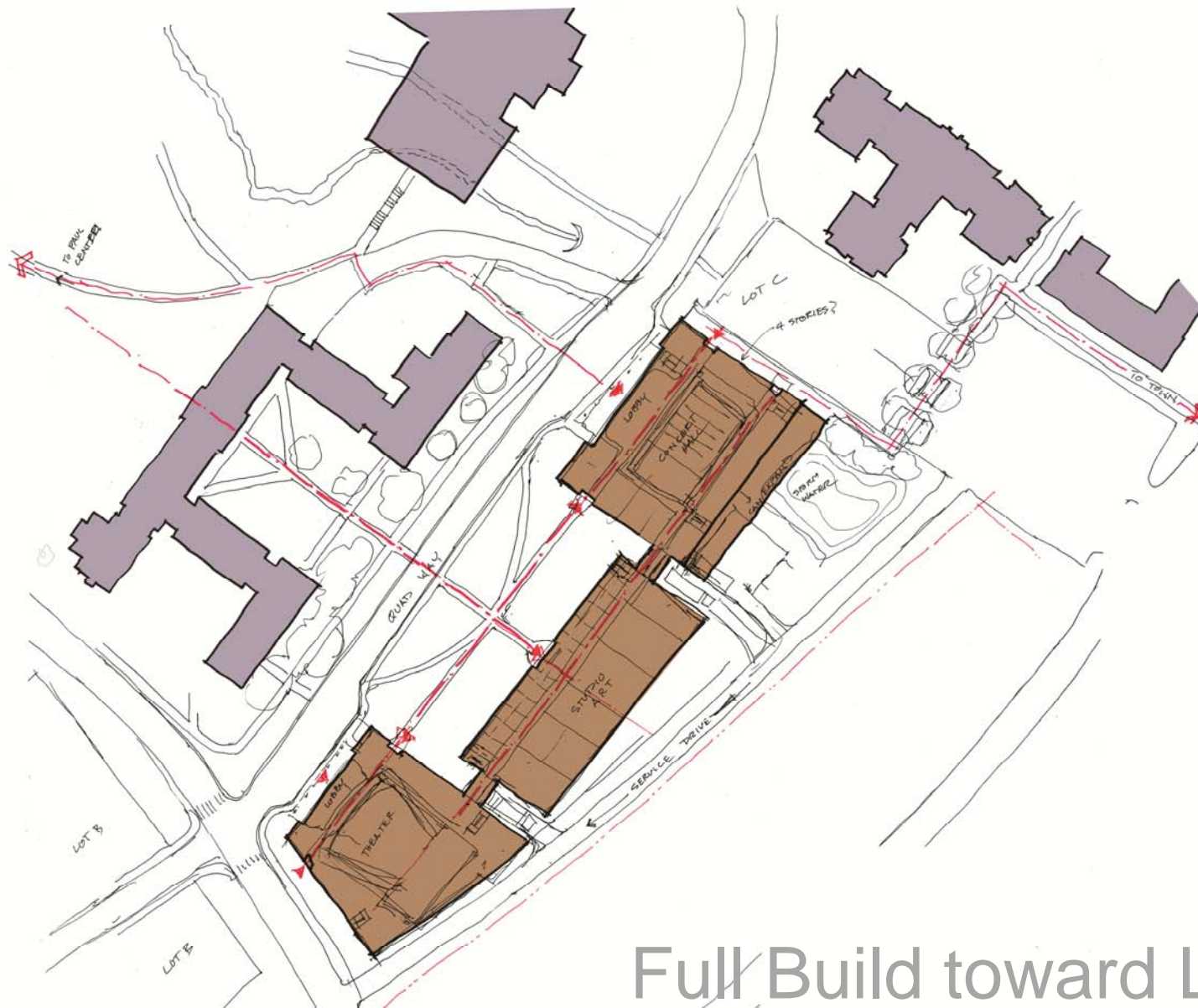

Full Build toward Lot B  
Hunter & Gibbs Demolished

There are 3 options for the Future Full Build Out of the Center for the Arts.



Full Build on Lot C

There are 3 options for the Future Full Build Out of the Center for the Arts.

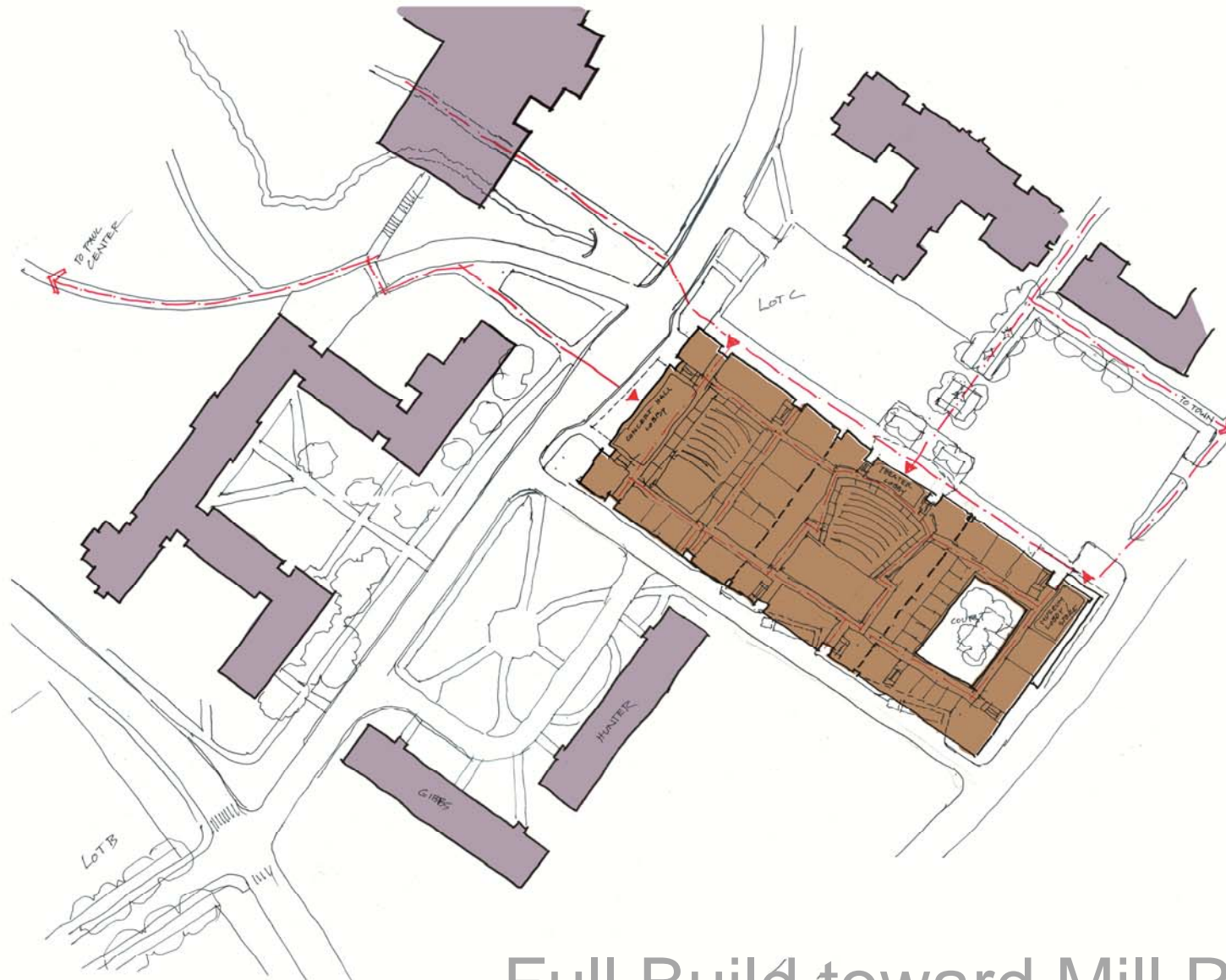

Full Build toward Mill Road



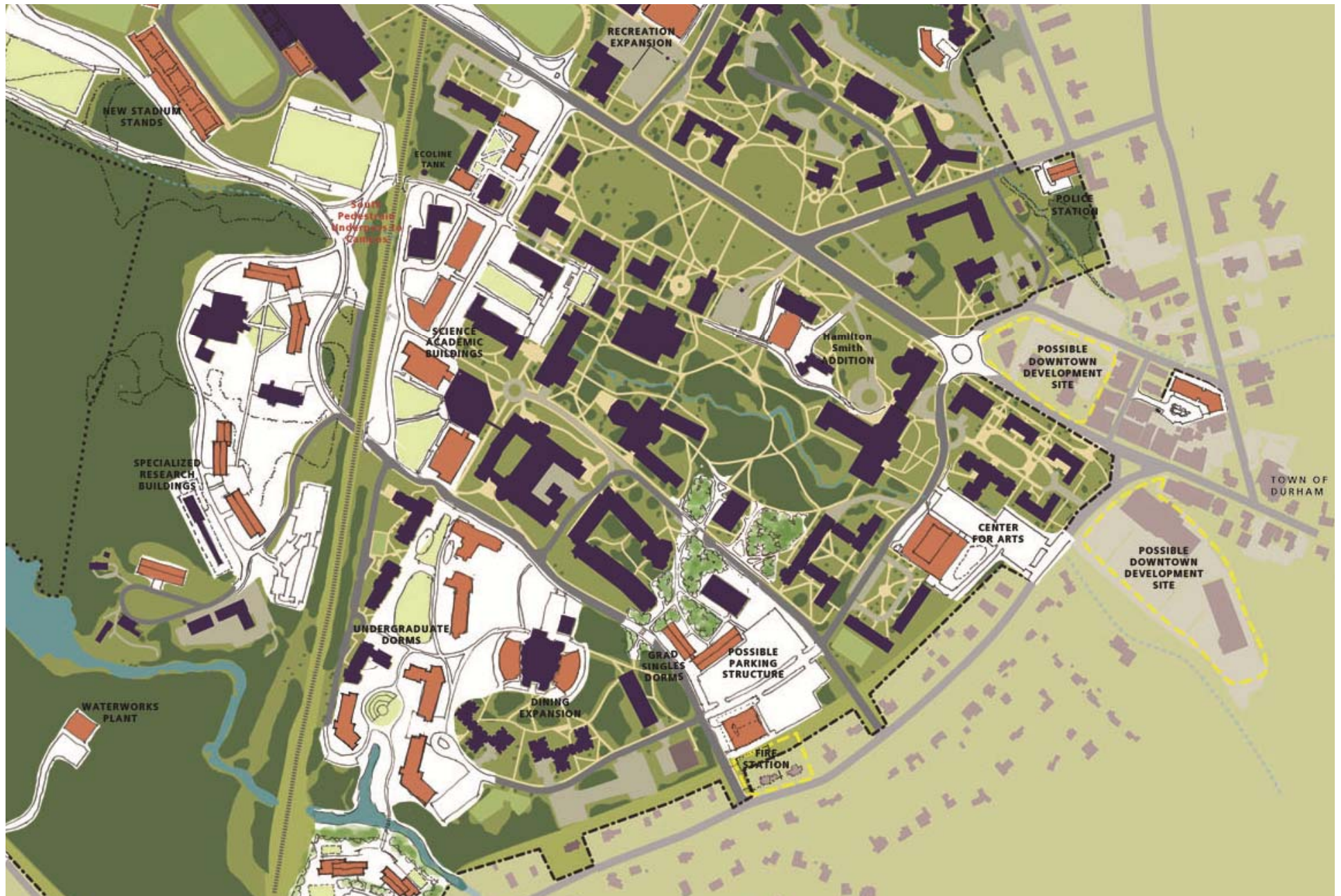

The PCAC will continue to be used to satisfy the rest of the space needs for the Arts until the Full Build Out of the Center for the Arts occurs.



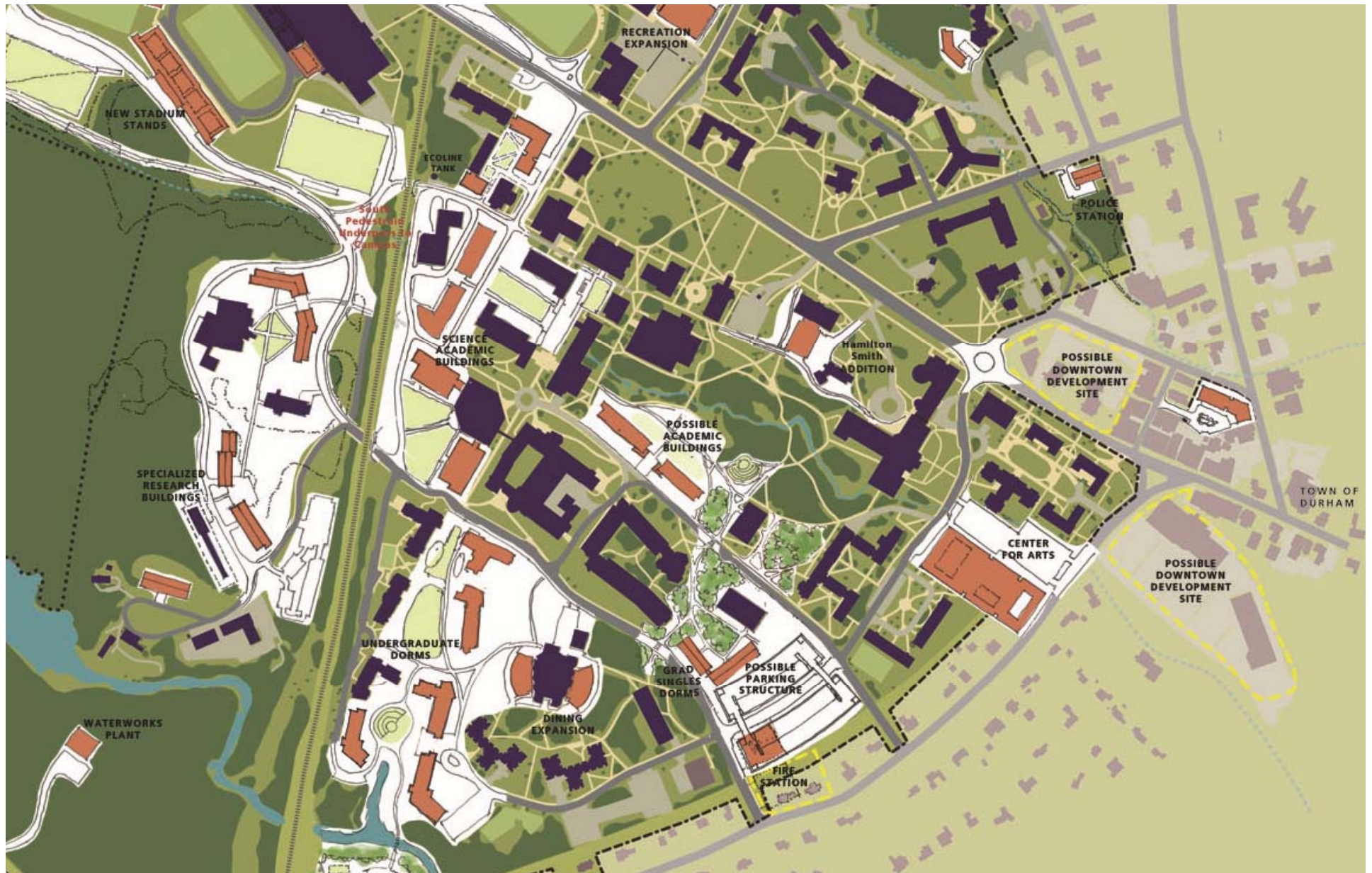

Not until all phases of the Center for the Arts are built can the PCAC be decommissioned. This site could then be used for new buildings that would serve science and technology programs.



An illustration of the massing and scale of the Center for the Arts



Phase 1